

Needle Valves

# Needle Valve - O.D.

Dwg No. IINV/OD

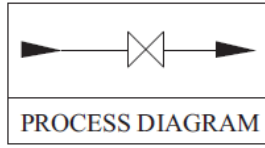

Orifice : 4 mm  
 Pressure : up to 6000 psi  
 Temperature : up to 400°C  
 All dimensions in Millimetre

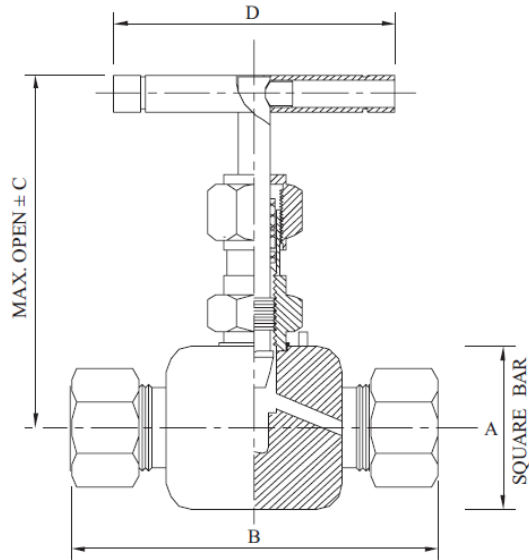

PART NO.	Size	A	B	±C	D
IINV/OD/01	1/8"	20	50	65	45
IINV/OD/02	1/4"	22	50	70	50
IINV/OD/03	3/8"	22	55	75	55
IINV/OD/04	1/2"	22	65	85	55
IINV/OD/05	3/4"	28	75	95	65
IINV/OD/06	1"	36	85	100	65
IINV/OD/07	1-1/4"	45	90	120	80
IINV/OD/08	1-1/2"	52	110	130	88
IINV/OD/09	2"	62	120	150	95